

STEERING COMMITTEE MEETING #2

July 20, 2019



AGENDA

Review

1. **Project History + Context**
2. **Stakeholders**
3. **Community Engagement Events + National Night Out**
4. **Pilot Site Improvements + Park Precedents**
5. **Project Schedules + Next Steps**

PROJECT HISTORY | VISION + ASPIRATIONS

Goals

- » **Transform Last Mile** into Baltimore
- » **Create a new destination and experience** for residents and visitors
- » **Increase public safety** through improved lighting and activation of new public space
- » **Increase community pride** with the installation of under-lighting artwork and sculptural element at a community gateway

Objectives

- » **Serve as a pilot site** for additional Amtrak underpass art installations
- » **Facilitate a community-centered placemaking process** that will create opportunities for resident engagement, leadership, ownership
- » **Provide a kit-of-parts design** for greening the open space and its components based on community feedback and direction
- » **Develop construction costs** for lighting installation, park elements, and green infrastructure

PROJECT HISTORY | COMMUNITY IDENTITY

- “Point of Pride”
- “History”
- “People doing good work”
- “This community is growing and changing in a positive way”
- “We are a developing community with lots of talent to give back to the community.”
- “Progressive-Minded People”
- “Mt. Tabor Baptist Church”
- “There are a lot of us in this neighborhood who welcome the revitalization and will help as much as possible.”
- “Key/Important People born here”
- “Social network wants to be restored”
- “A lot of recent housing development”
- “Want to bring people together”
- “Eager Park”
- “Religious community and churches”
- “North of the Tracks”

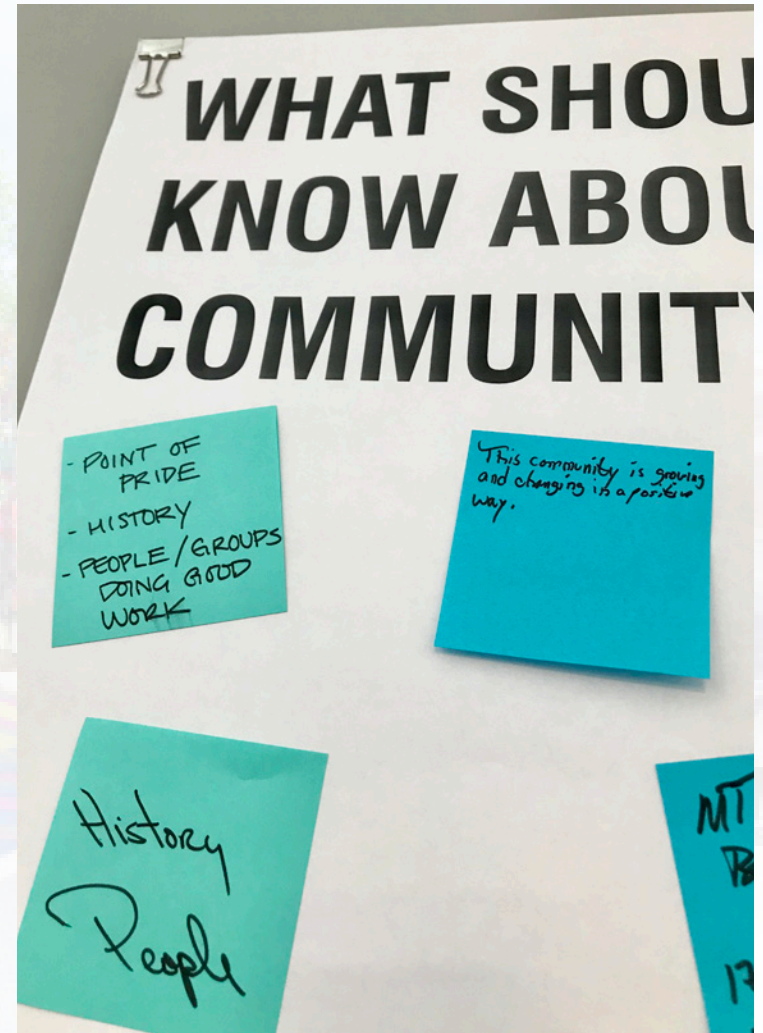

PROJECT HISTORY | DESIGN INPUT

Design Sliders

WHERE DO YOU LAND?



RYKEL
 Project: LAST MILE @ SOUTH + EAST - Community Engagement
 Date: 02.18.18

Design Sliders

WHERE DO YOU LAND?



RYKEL
 Project: LAST MILE @ SOUTH + EAST - Community Engagement
 Date: 02.18.18

Design Sliders

WHERE DO YOU LAND?



RYKEL
 Project: LAST MILE @ SOUTH + EAST - Community Engagement
 Date: 02.18.18

STAKEHOLDERS

- American Communities Trust
- Baltimore Green Network
- Baltimore City Planning Department
- Baltimore City Police Department
- City Life Community Builders
- Councilmember Stokes and office
- Eager Park Neighborhood Association
- East Baltimore Development Inc.
- Israel Baptist Church
- New Broadway East Community Assoc.
- NBECA - Collington Square
- ReBuild Metro
- Strong City Baltimore
- The 6th Branch

CURRENT.

POTENTIAL...

PROJECT CONTEXT



East Baltimore Revitalization Project (EBRP) . GBC Trestle Park Report . Baltimore Green Tracks .
Baltimore Green Network Plan . Baltimore 2019 Sustainability Plan . City Council Open Space Task Force

PARK EXTENTS + ANCHOR SITES

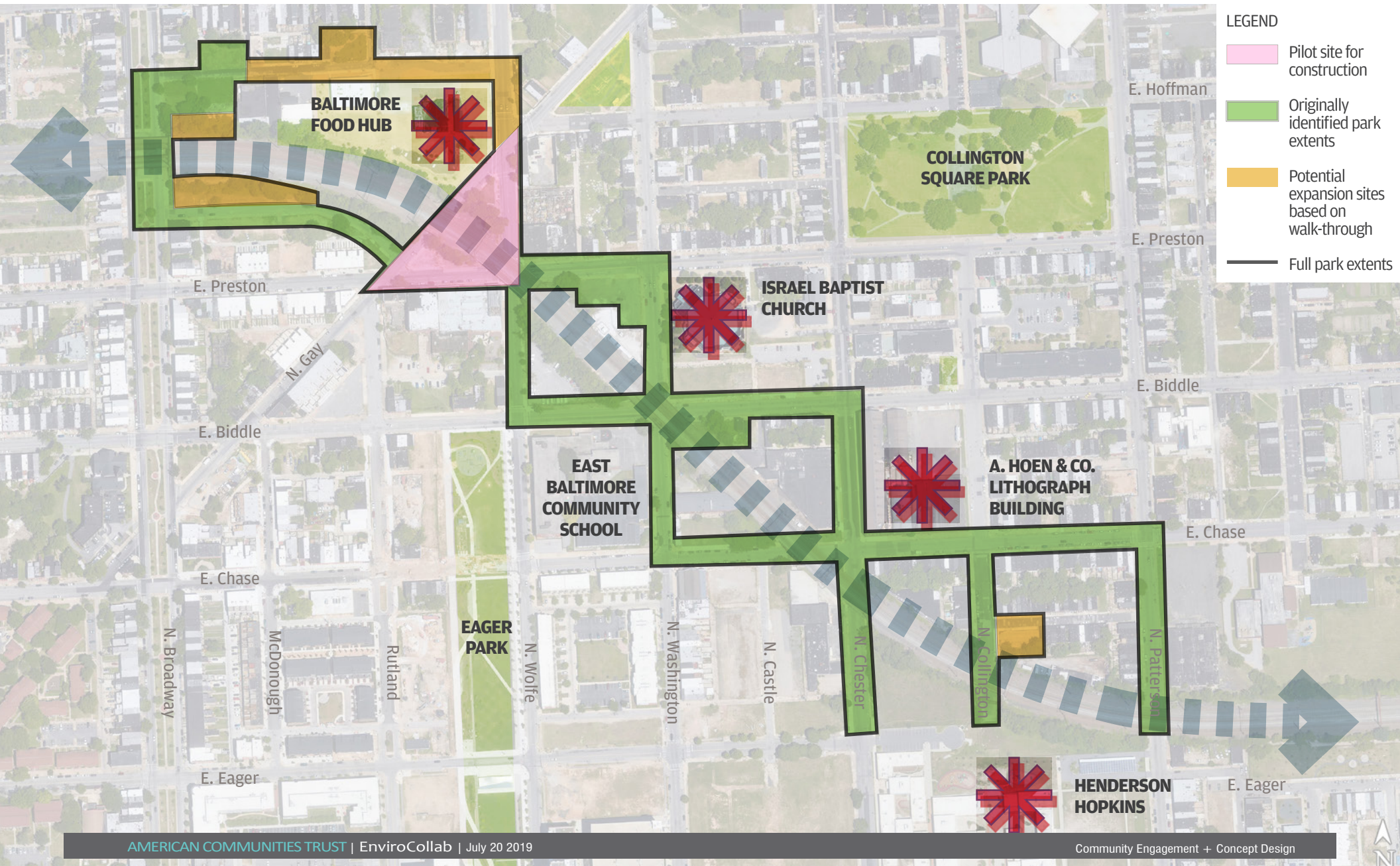

PARK CONNECTIONS

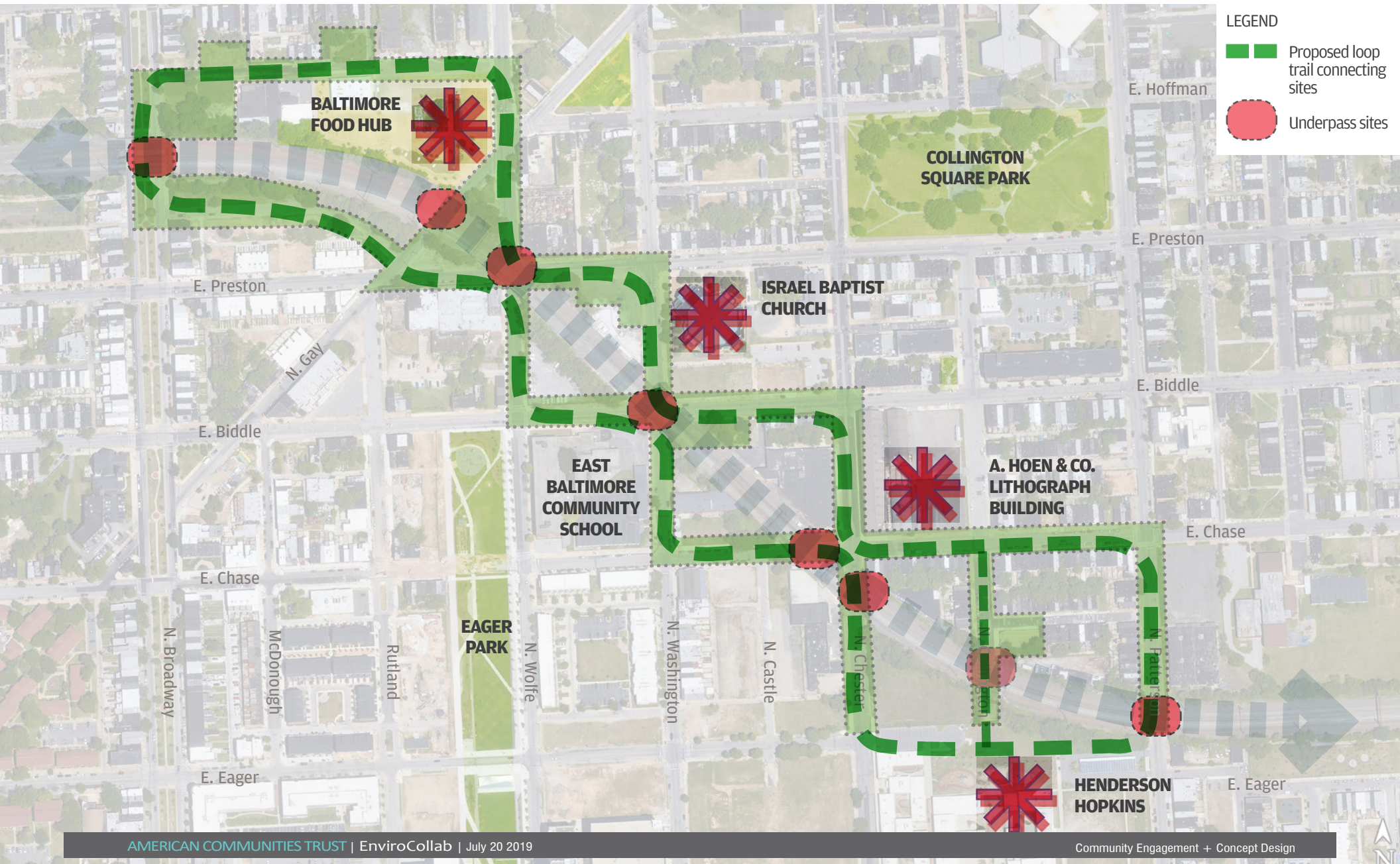

OPEN SPACE | SPACES + CORRIDORS

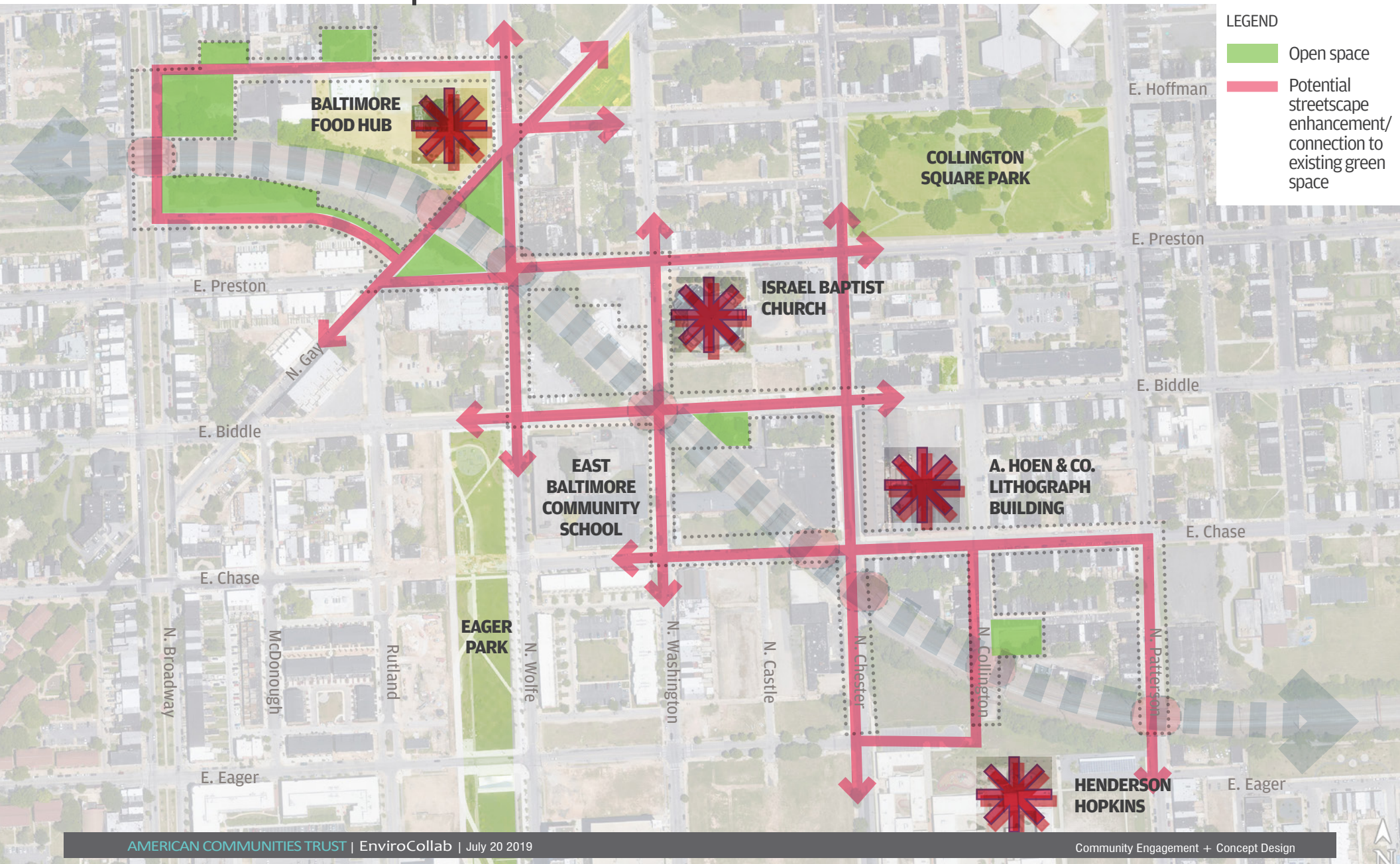

PILOT SITE | PREVIOUS CONCEPT DESIGN

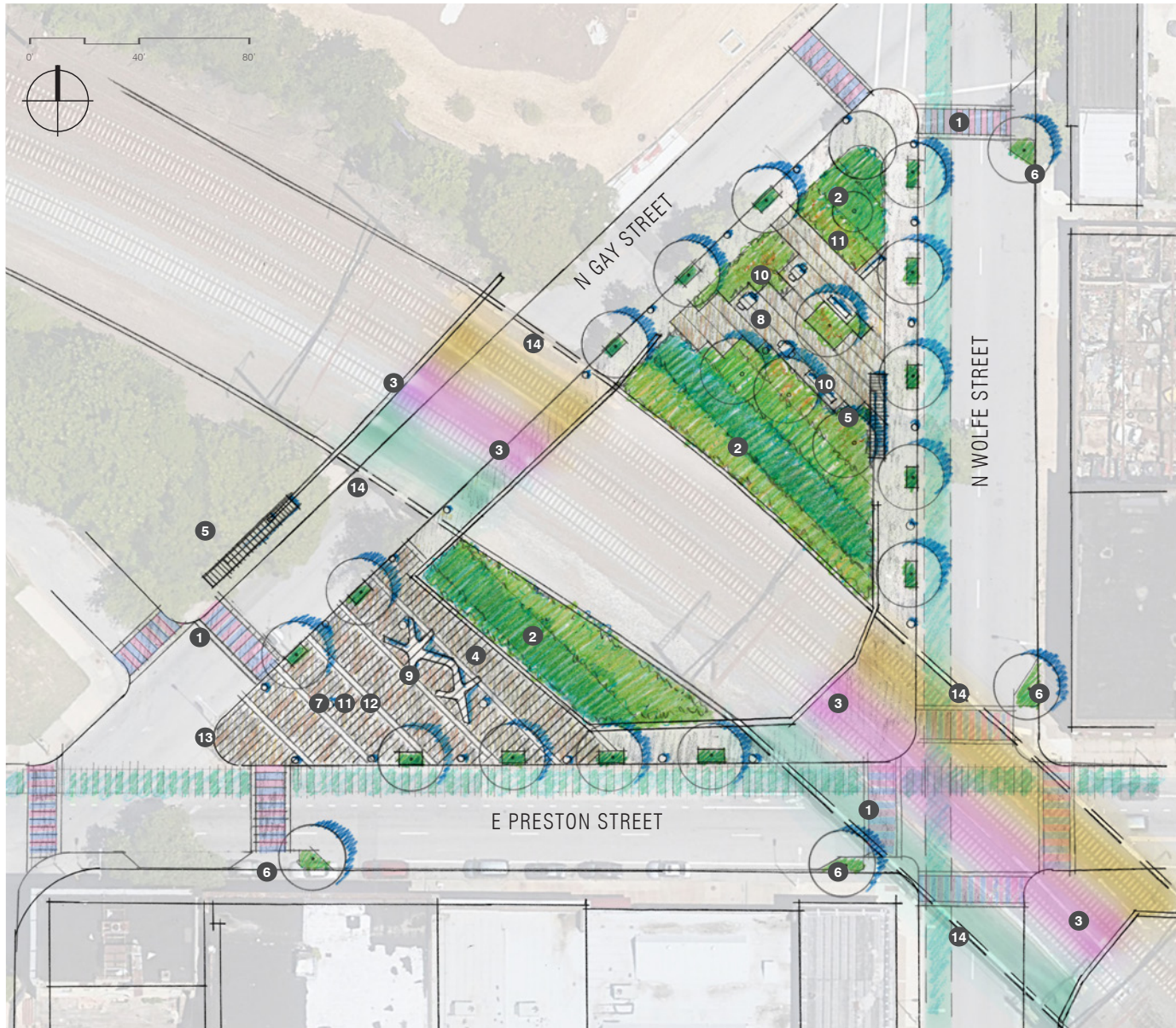

LEGEND:

- 1** ARTISTIC CROSSWALK PAINTING
- 2** ENHANCED PLANTING
- 3** LIGHTING AT UNDERPASS
- 4** COMMISSIONED MURAL ON AMTRAK RETAINING WALL
- 5** CUSTOM WOOD AND STEEL BUS SHELTER
- 6** CURB EXTENSIONS (BUMP-OUTS) ON WOLFE AND PRESTON STREETS
- 7** SOUTH PARCEL PERVIOUS PAVEMENT
- 8** SEATING AREAS AT NORTH PARCEL W/ PERVIOUS PAVEMENT
- 9** PLAZA FURNISHINGS IN SOUTH PARCEL
- 10** SITE FURNISHINGS IN NORTH PARCEL
- 11** ADDITIONAL PEDESTRIAN POLE LIGHTING IN NORTH AND SOUTH PARCELS
- 12** CATENARY LIGHTING @ SOUTH PARCEL
- 13** NEIGHBORHOOD SIGNAGE
- 14** PAINTED AMTRAK BRIDGE

PILOT SITE | R.O.W. IMPROVEMENTS

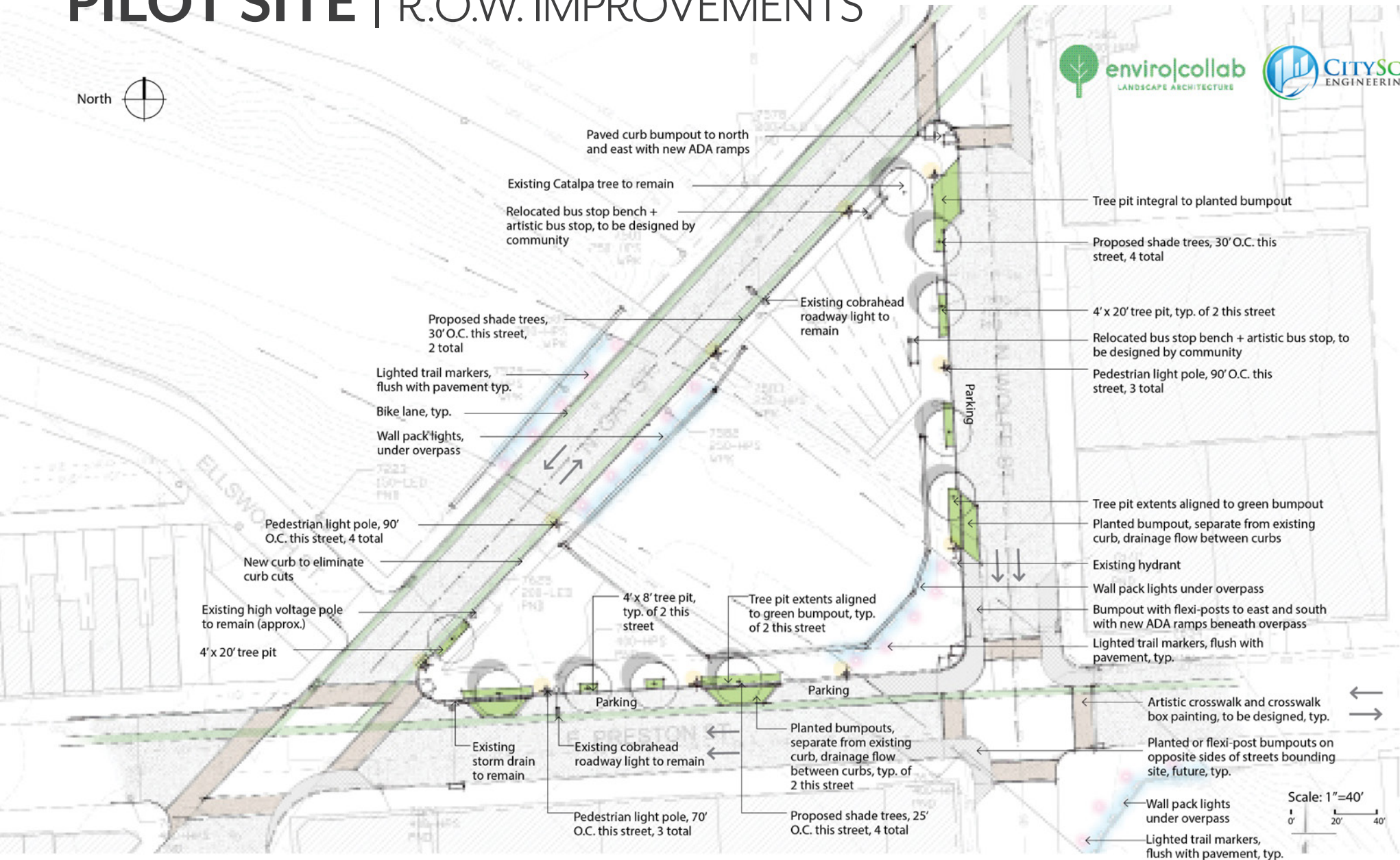

Scale: 1"=40'
0' 20' 40'

PARK THEMING | PRECEDENTS



PARK THEMING | PRECEDENTS



CROSSWALK MURAL | PRECEDENTS



CROSSWALK MURAL | PRECEDENTS (PATTERNS)

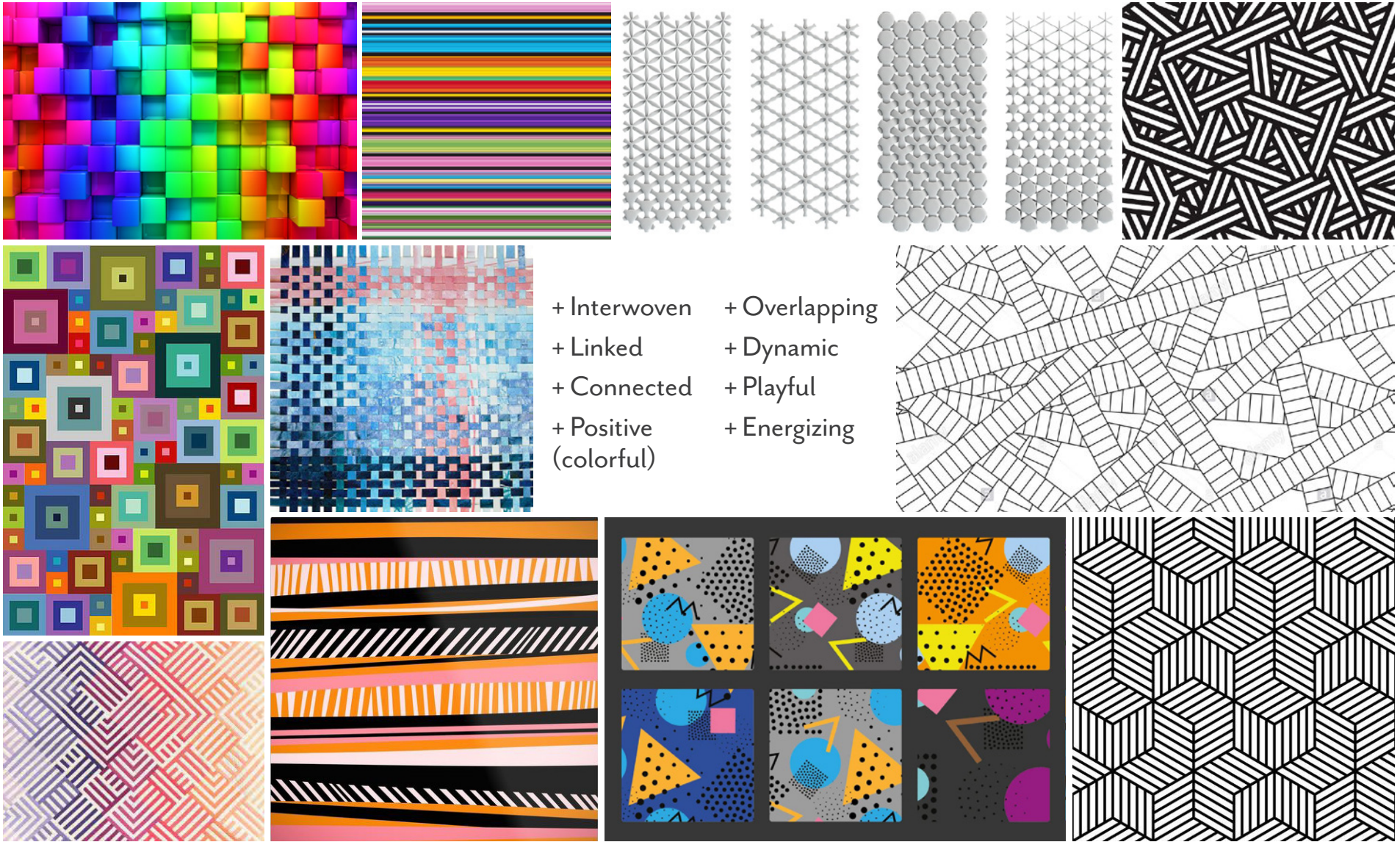

CROSSWALK MURAL | PRELIMINARY IDEAS

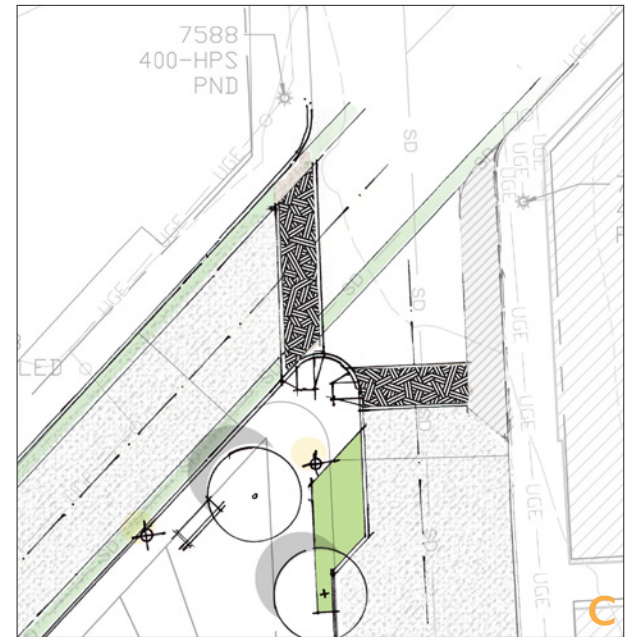
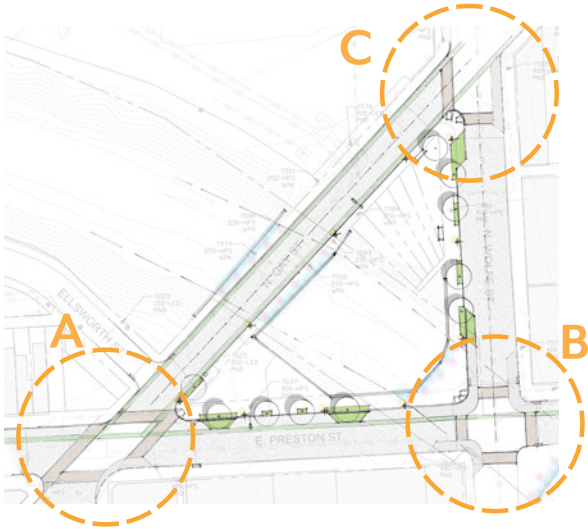

GREEN STREETS | PRECEDENTS

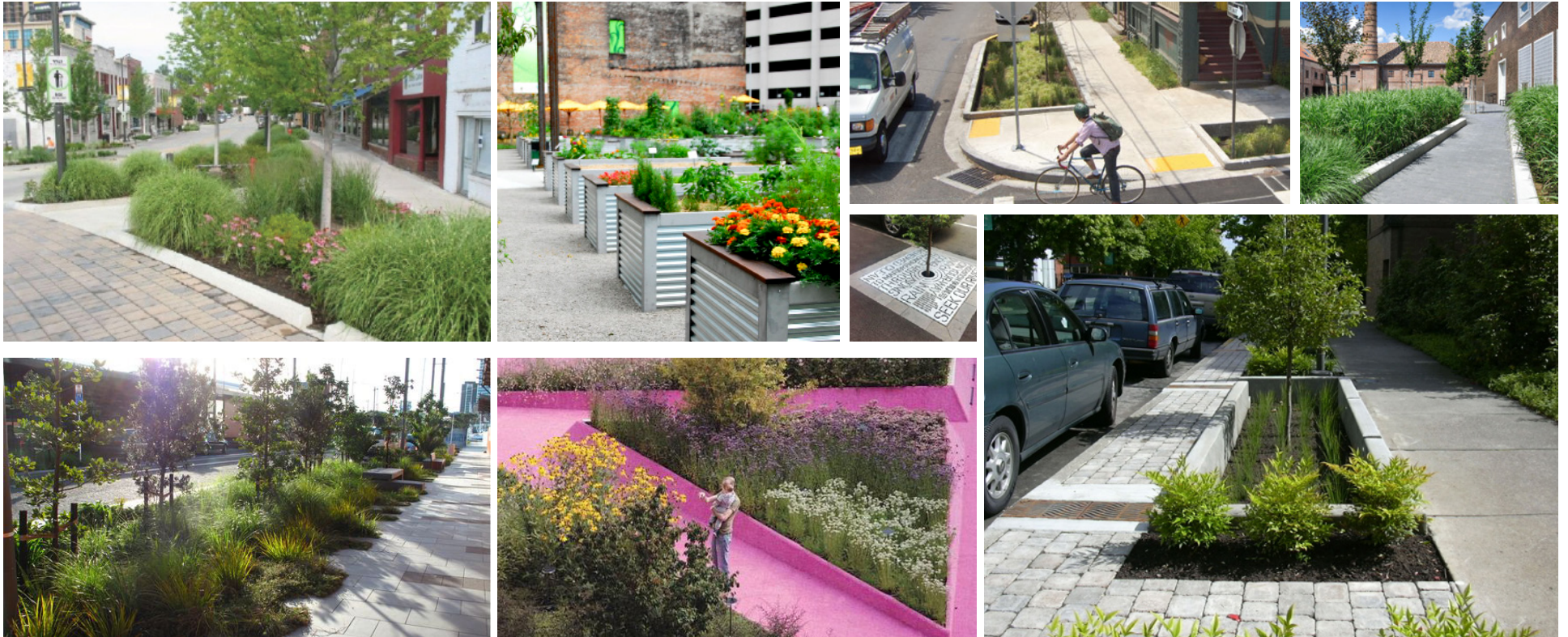

CRITICAL PATH DATES | L.M.P. PILOT SITE ENGINEERING

Steering Committee Kickoff June 25

Progress Meeting w/ Steering Committee #2
design updates July 20

Progress Meeting w/ Executive Committee
60% design update Aug 13

60% Design Plans Due Week of Sept 2

Progress Meeting w/ Steering Committee #3
90% design update Sept 21

Community Meeting #1 Sept 26

90% Design Plans Due Oct 14

100% Design Plans Due Dec 2

Abell Report Due Feb 24

CRITICAL PATH DATES | L.M.P. CONCEPT DESIGN



Steering Committee Kickoff #1	June 25
City Agency Kickoff Meeting	July 31
Coffee Stand Pop-Up / Site Tour	Sept 14
Progress Meeting w/ Steering Committee #2 preliminary concept plan due	Sept 21
Community Meeting #1	Sept 26
Progress Meeting w/ Steering Committee #3 final concept plan due	Dec 21
Community Meeting #2	Jan 23
Abell Report Due	Feb 24

COMMUNITY ENGAGEMENT | DATES



POSTCARD/FLIER
05.24.18 Workshop



POSTCARD/FLIER
06.20.19 Meeting

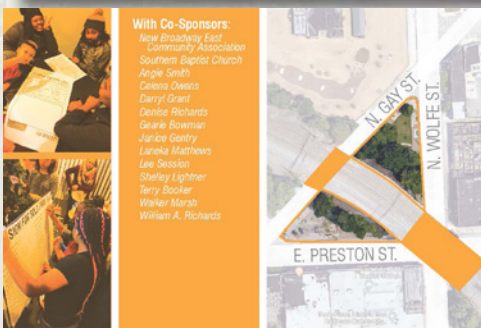

National Night Out // TUESDAY Aug.6th

Coffee Pop-Ups* // SATURDAY Sep.14th

NBECA Community Meeting #1 // THURSDAY Sep.26th

NBECA Community Meeting #2 // THURSDAY Oct.24th

NBECA Community Meeting #3 // THURSDAY Jan.23rd

COMMUNITY ENGAGEMENT | STRATEGIES

DESIGN SLIDERS

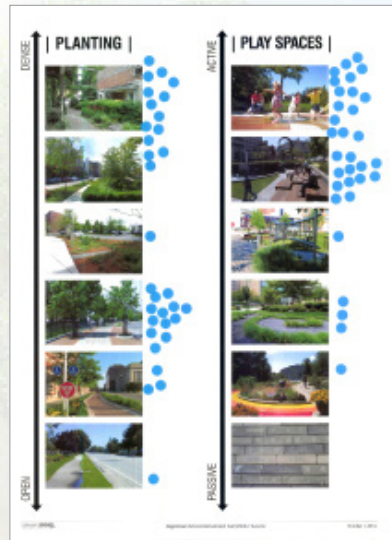

Visual Preferences + Visioning



SWOT Analysis

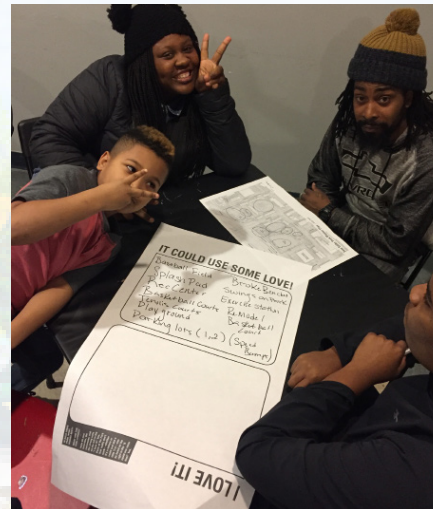

Site Evaluation

Seventh Street Fountain Park
April 27, 2013
MAHAN RYKIEL ASSOCIATES

Site Evaluation

Character & Condition	POOR	GOOD
Appearance of space	dated / uninviting (2)	3 4
Organization of space	Separate spaces (1)	(3) 3 4
Plant material condition	Some good / some struggling (2)	(3) 3 4
Pavement condition	POOR concrete on lot (2)	3 4
Site furnishings condition	dated / little / missing (1)	2 3 4
Seating opportunities	odd - not really seating (1)	2 3 4
Site lighting	unknown (1)	2 3 4
Safety of space	feels unsafe re: traffic (1)	(2) 3 4
AVERAGE RATING:	13 / 18 = 0.72	0.6

Connectivity & Context

	POOR	GOOD
Visibility of space	Visible from (1)	2 (3) 4
Accessibility of space	POOR physical access (1)	2 3 (4) 4
Location of space	people walk a path (1)	2 (3) 4
Context of space	fit in w/ open space around it - parking lot (1)	(2) 3 4
AVERAGE RATING:	12 / 14 = 0.86	0.8

Use & Value

	POOR	GOOD
Event frequency	none (1)	2 3 4
Activity within space	really seen anyone here (1)	2 3 4
Activity surrounding space	people hang out on bench (1)	2 (3) 4
Overall use of space	is it used? (1)	2 3 4
Economic benefit of space	could be better (1)	2 3 4
Historic value of space	could be improved (1)	2 3 (4) 4
Civic value of space	unattractive (1)	(2) 3 4
AVERAGE RATING:	13 / 17 = 0.76	0.9

How do you use currently use this space?
It reminds me that I need to stop at the @ lane to go straight on the @ lane to go left @ this point on N Market.
Today is the first time that I've set foot in the "park."
I admire the mystery.

Table Discussions



Dot Mapping





THANK YOU.